





**SSCT**

*"For Nation's Greater Heights"*

S.5. Space is provided for print resources as well as work stations for electronic resources.

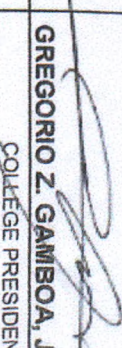
	COLLEGE LOGO:	BY DIRECT SUPERVISION:	 <b>AR MARLEN C. SOLLOSO</b> HEAD BUILDINGS & ESTATES
<b>LOCATION MAP</b>		PROJECT TITLE:	LOCATION: SSCT-MAIN CAMPUS, SURIGAO CITY, SDN
RECOMMENDING APPROVAL:		 <b>ROWENA A. PLANDO, Ph.D.</b> VICE-PRESIDENT for ADMINISTRATION	
APPROVED:		 <b>GREGORIO Z. GAMBA, Jr., Ed.D</b> COLLEGE PRESIDENT	
CONTENT:		SHEET NO. <span style="border: 1px solid black; border-radius: 50%; width: 30px; height: 30px; display: inline-block; vertical-align: middle; margin-left: 10px;"></span>	

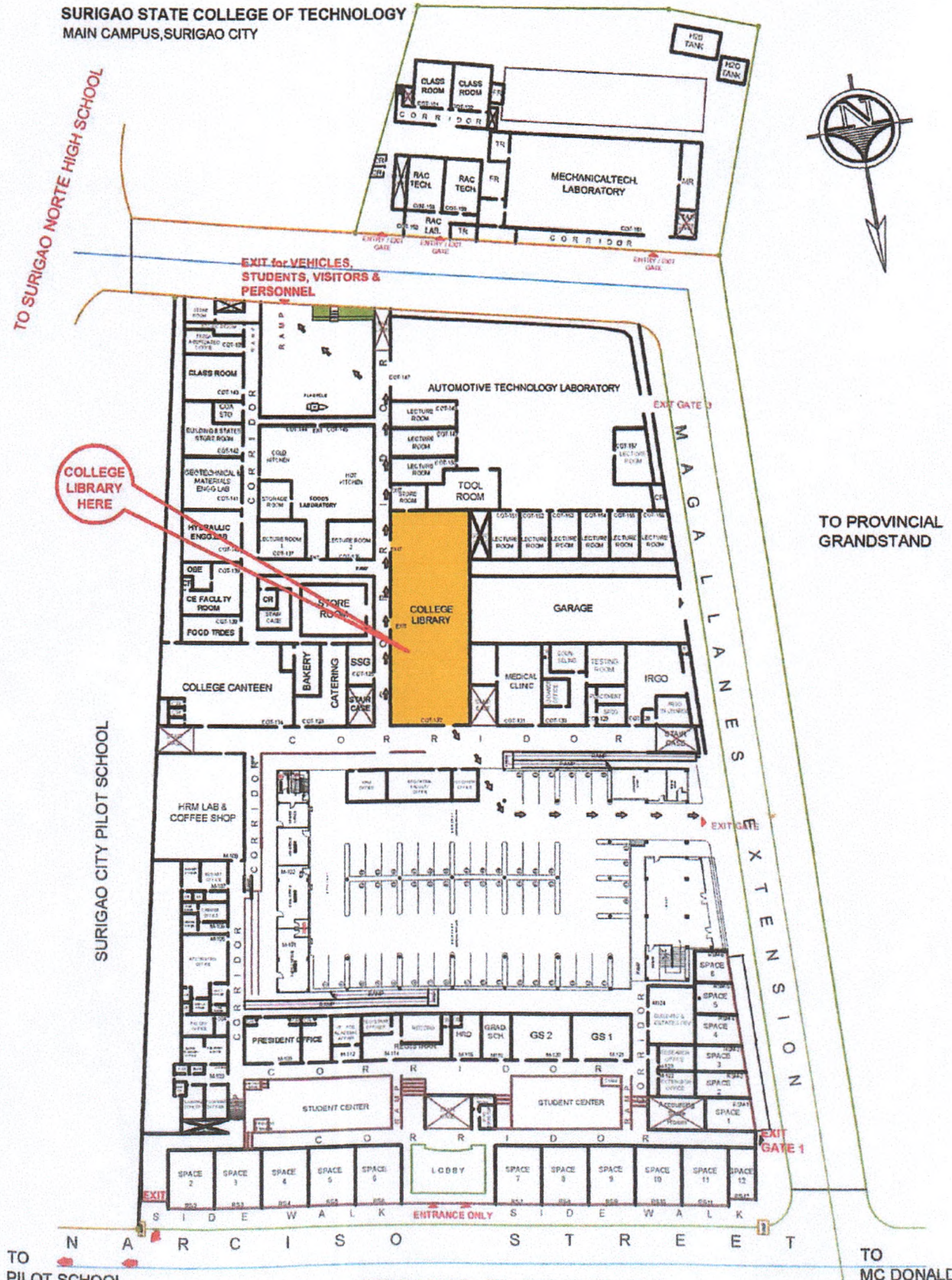

**GROUND FLOOR PLAN**  
SCALE 1:500 M

**COLLEGE LIBRARY**

**SURIGAO STATE COLLEGE OF TECHNOLOGY  
MAIN CAMPUS, SURIGAO CITY**

**EVACUATION AREA**



TO SURIGAO NORTE HIGH SCHOOL

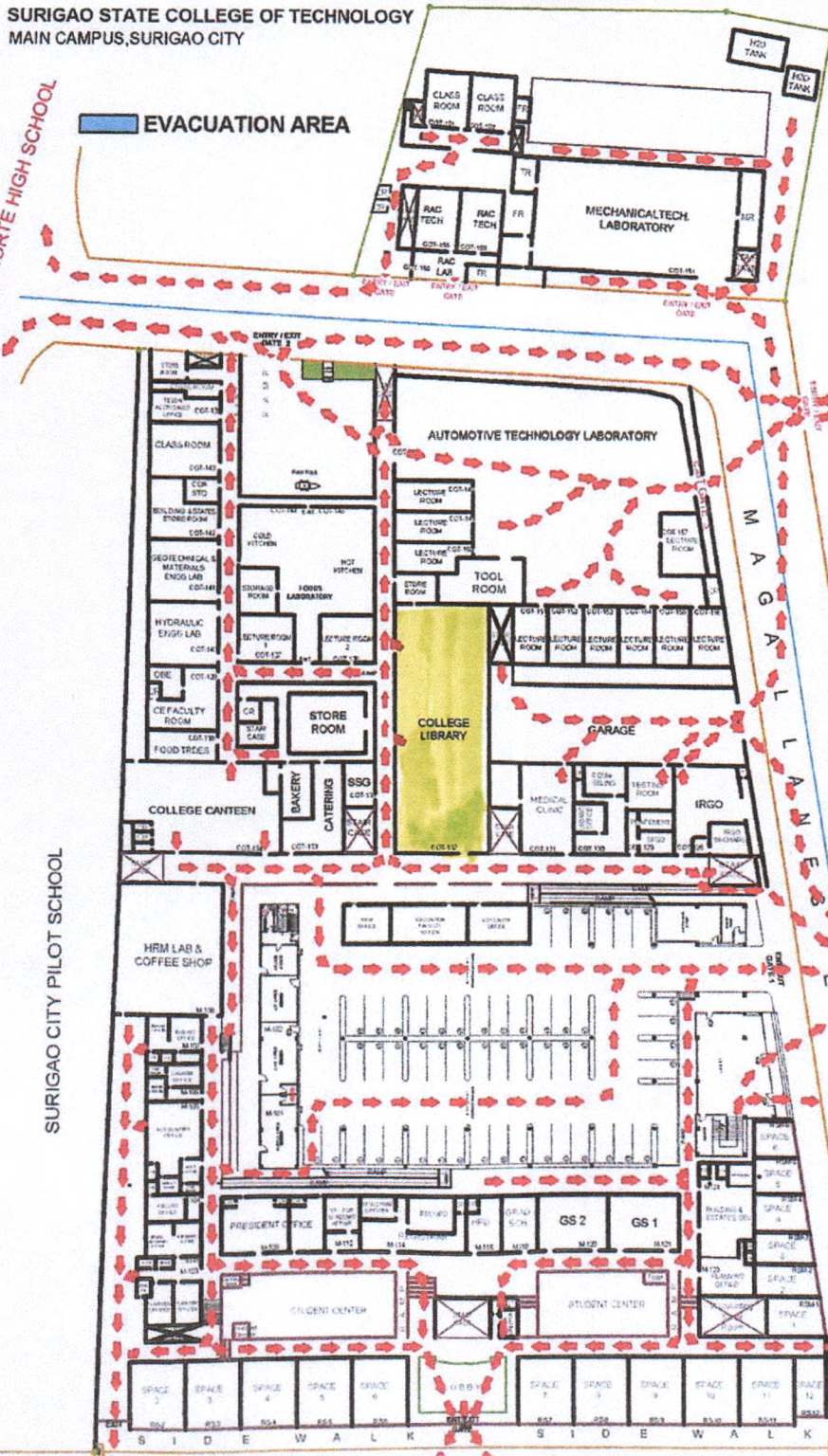

**EMERGENCY NUMBER**

- BFP: 232-7790/827-0318**
- CRH: 862-1800/826-3876**
- PNP HOTLINE: 09209745322**
- PDRM: 09282105287**
- CDRRMC: 826-5449/09106217684**
- RESCUE: 09294209511**

PROVINCIAL SPORTS  
COMPLEX

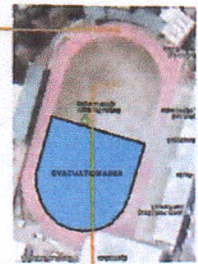

TO PROVINCIAL  
GRANDSTAND



TO TENSION



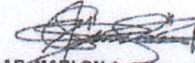
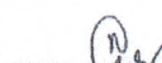

TO PILOT SCHOOL

TO MC DONALD

**GROUND FLOOR PLAN**

SCALE 1:500

LOGO	BY DIRECT SUPERVISION	PROJECT TITLE	RECOMMENDING APPROVAL	APPROVED	SHEET CONTENTS	SHEET NO
	 <b>AR. MARLON C. SOLLOSA</b>	<b>EMERGENCY EXIT PLAN/ EVACUATION EXIT PLAN</b>	 <b>ROWENA A. PRADO, Ph.D.</b>	 <b>GREGORIO Z. GAMBOA, JR., Ed.D.</b>		
SSCT	HEAD BUILDINGS & ESTATES	LOCATION: SSCT-MAIN CAMPUS, NARCISO ST., SURIGAO CITY	VICE-PRESIDENT for ADMINISTRATION	COLLEGE PRESIDENT		

 <p>COLLEGE LOGO:</p>	<p>BY DIRECT SUPERVISION:</p>	<p>PROJECT TITLE:</p>	<p>RECOMMENDING APPROVAL:</p>	<p>APPROVED:</p>	<p>CONTENT:</p>	<p>SHEET NO:</p>
<p>SSCT</p> <p>AR. MARLEN C. SOLLOSO</p> 	<p>HEAD BUILDINGS &amp; ESTATES</p>	<p>LOCATION MAP</p>	<p>TO SURIGAO NORTE HIGH SCHOOL</p>	<p>TO SURIGAO CITY PILOT SCHOOL</p>	<p>TO PROVINCIAL GRANDSTAND</p>	<p>TO NARCISO STREET</p>
<p>LOCATION: SSCT-MAIN CAMPUS, SURIGAO CITY, SDN</p>	<p>TO SURIGAO NORTE HIGH SCHOOL</p>	<p>SURIGAO CITY PILOT SCHOOL</p>	<p>TO SURIGAO CITY PILOT SCHOOL</p>	<p>TO SURIGAO CITY PILOT SCHOOL</p>	<p>TO SURIGAO CITY PILOT SCHOOL</p>	<p>TO SURIGAO CITY PILOT SCHOOL</p>
<p>ROWENA A. PANDANO, Ph.D.</p>  <p>VICE-PRESIDENT for ADMINISTRATION</p>	<p>TO SURIGAO NORTE HIGH SCHOOL</p>	<p>SURIGAO CITY PILOT SCHOOL</p>	<p>TO SURIGAO CITY PILOT SCHOOL</p>	<p>TO SURIGAO CITY PILOT SCHOOL</p>	<p>TO SURIGAO CITY PILOT SCHOOL</p>	<p>TO SURIGAO CITY PILOT SCHOOL</p>
<p>GREGORIO Z. GAMBOA, Jr., Ed.D.</p>  <p>COLLEGE PRESIDENT</p>	<p>TO SURIGAO NORTE HIGH SCHOOL</p>	<p>SURIGAO CITY PILOT SCHOOL</p>	<p>TO SURIGAO CITY PILOT SCHOOL</p>	<p>TO SURIGAO CITY PILOT SCHOOL</p>	<p>TO SURIGAO CITY PILOT SCHOOL</p>	<p>TO SURIGAO CITY PILOT SCHOOL</p>

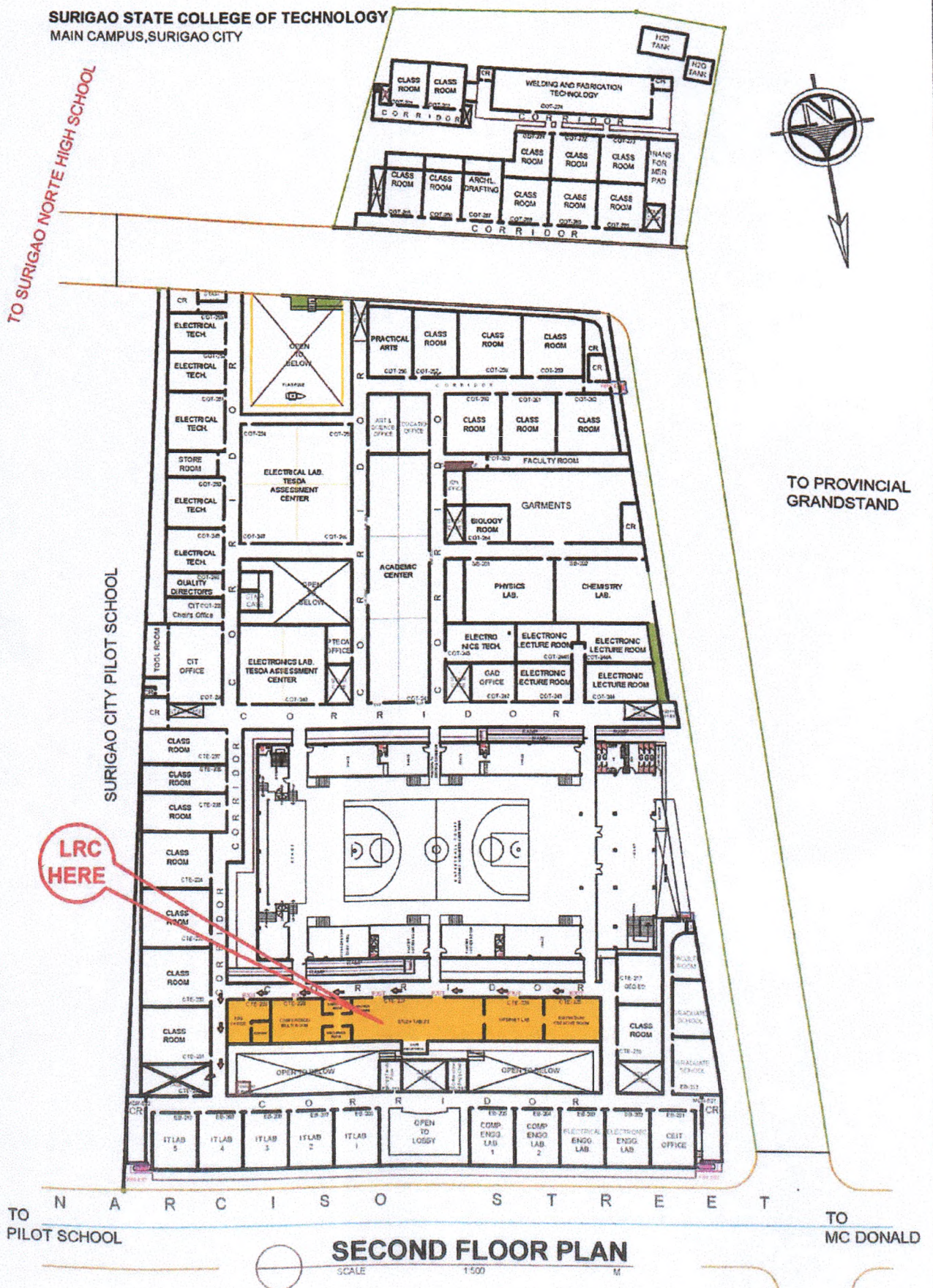

**SURIGAO STATE COLLEGE OF TECHNOLOGY  
MAIN CAMPUS, SURIGAO CITY**

TO SURIGAO NORTE HIGH SCHOOL

**EVACUATION AREA**

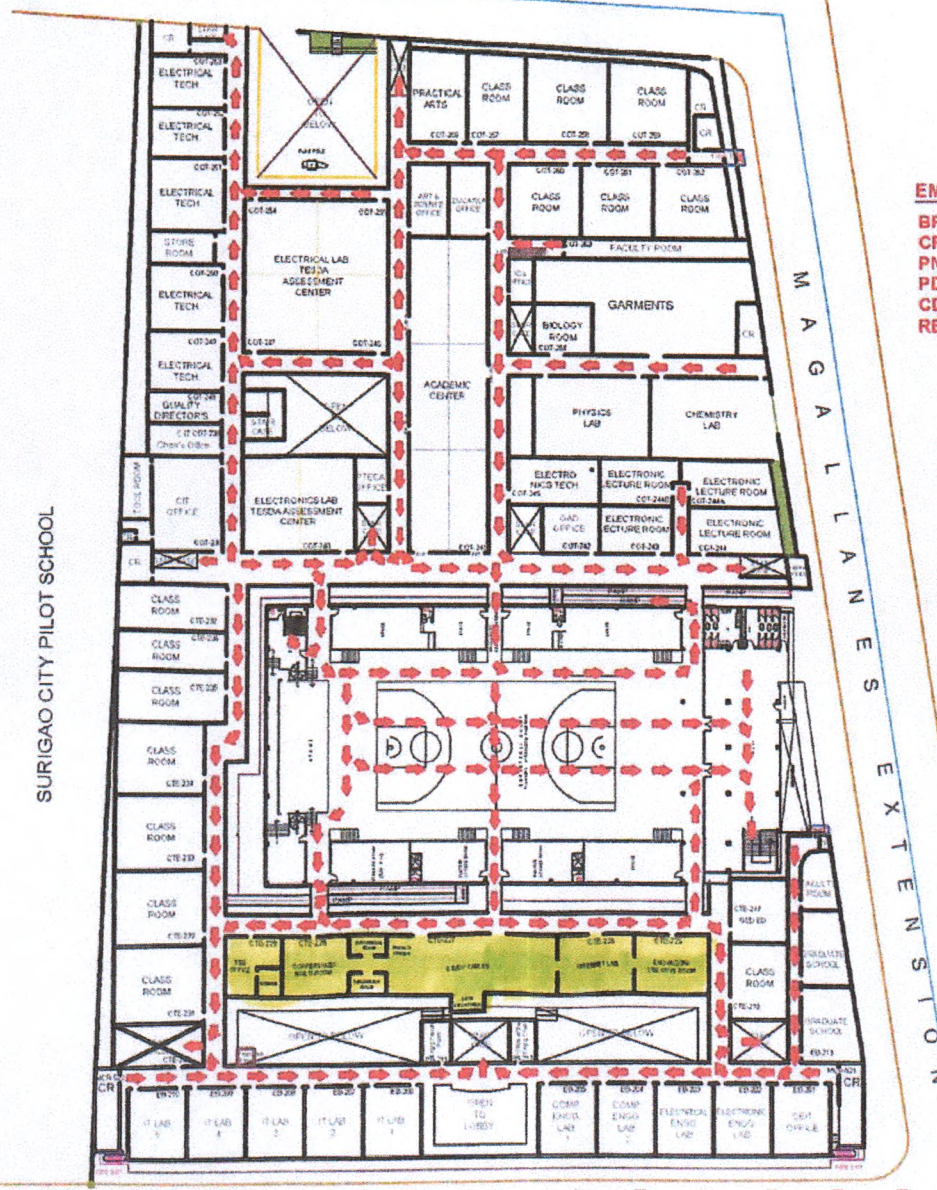

**EMERGENCY NUMBER**

- BFP:** 232-7790/827-0318
- CRH:** 862-1800/826-3876
- PNP HOTLINE:** 09209746322
- PDRRC:** 09282105287
- CDRRMC:** 826-5449/09106217684
- RESCUE:** 09294209511

PROVINCIAL SPORTS  
COMPLEX

TO PROVINCIAL  
GRANDSTAND

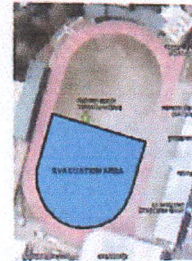

SURIGAO CITY PILOT SCHOOL

MAGALLANES  
EXTENSION

TO  
PILOT SCHOOL

TO  
MC DONALD

N A R C I S O S T R E E T

**SECOND FLOOR PLAN**

SCALE 1:500 M



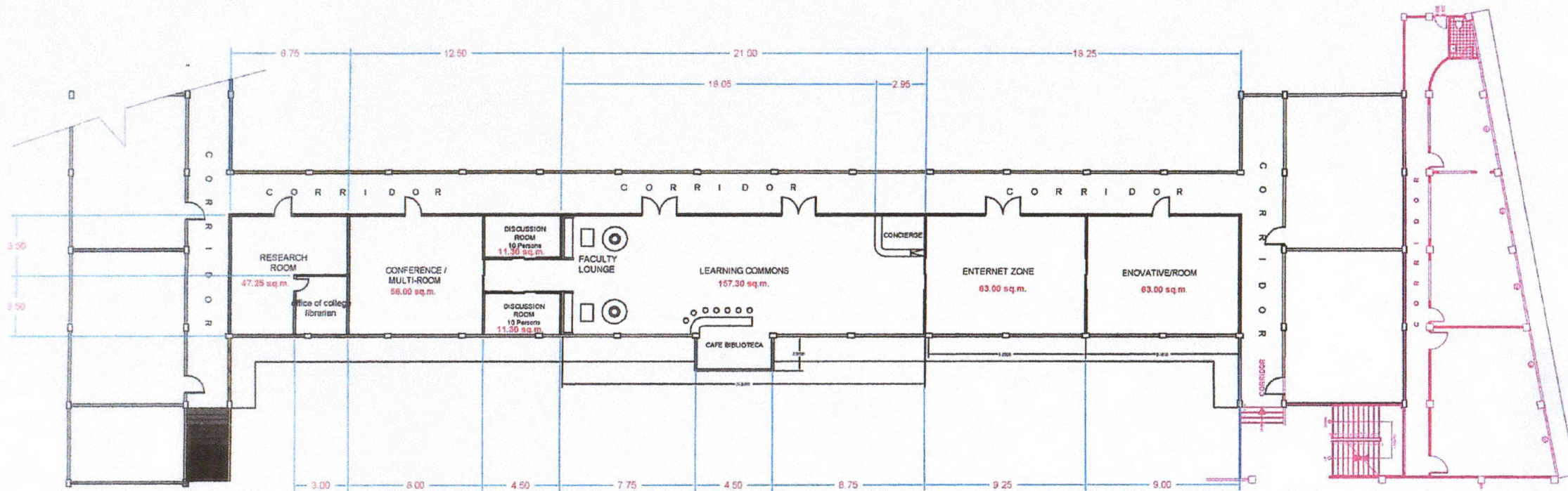

LOGO	BY DIRECT SUPERVISION	PROJECT TITLE	RECOMMENDING APPROVAL	APPROVED	SHEET CONTENTS	SHEET NO.
	 <b>AR. MARLON C. SOLLOSO</b>	<b>EMERGENCY EXIT PLAN/ EVACUATION EXIT PLAN</b>	 <b>ROWENA A. PRADO, Ph.D.</b> VICE-PRESIDENT for ADMINISTRATION	 <b>GREGORIO Z. GAMBOA, JR., Ed.D.</b> COLLEGE PRESIDENT		⊕
SSCT	HEAD BUILDINGS & ESTATES	LOCATION <b>SSCT-MAIN CAMPUS, NARCISO ST., SURIGAO CITY</b>				



**AREA 555.75 SQ.**

**SECOND FLOOR PLAN**  
SCALE 1:300 M.

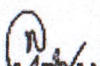
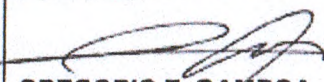
**SEATING CAPACITY: 500 STUDENTS  
(LEARNING RESOURCE CENTER)**

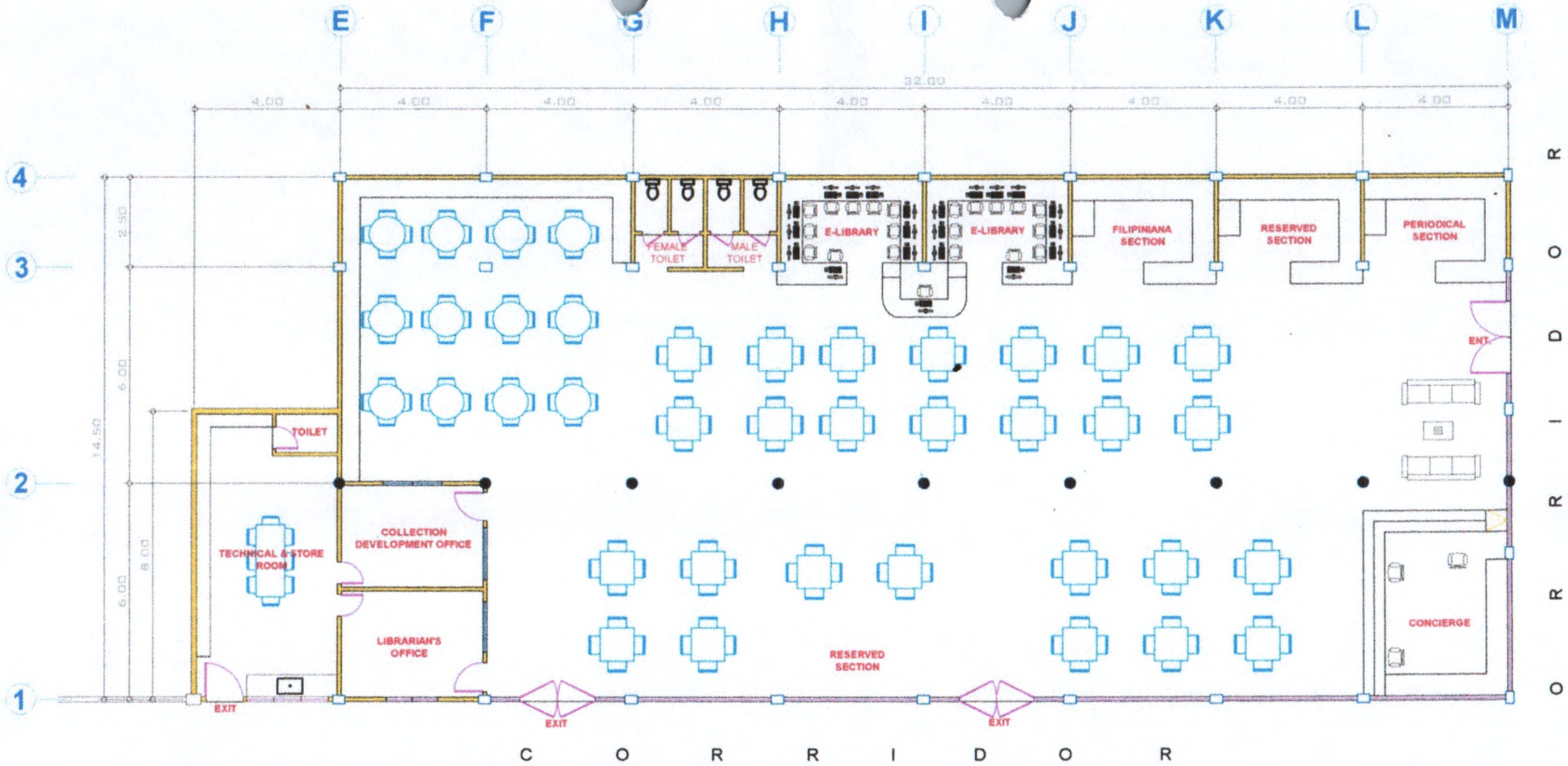

COLLEGE LOGO:	BY DIRECT SUPERVISION :	PROJECT TITLE :	RECOMMENDING APPROVAL:	APPROVED:	CONTENT:	SHEET. NO.:
	 <b>AR. MARLON C. SOLLOSO</b> HEAD BUILDINGS & ESTATES	<b>LEARNING RESOURCE CENTER</b> LOCATION: SSCT-MAIN CAMPUS, SURIGAO CITY , SDN	 <b>ROWENA A. PLANDO, Ph.D.</b> VICE-PRESIDENT for ADMINISTRATION	 <b>GREGORIO Z. GAMBOA, Jr., Ed.D</b> COLLEGE PRESIDENT		

COPYRIGHT + CAD - JONAS E. DELACRUZ ALL RIGHTS RESERVED - 2009



**AREA 496 SQ.**

**FLOOR PLAN**  
SCALE: 1:150 METERS

 SSCT	BY DIRECT SUPERVISION: <b>VIRNE P. PORTUGUES</b> RESIDENT ENGINEER	PROJECT TITLE: <b>COLLEGE LIBRARY LAYOUT PLAN</b> LOCATION: SSCT-MAIN CAMPUS, SURIGAO CITY, SDN	RECOMMENDING APPROVAL: <i>Gideon A. Ebarsabal</i> <b>GIDEON A. EBARSABAL, Ph.D.</b> VICE-PRESIDENT for ADMINISTRATION	APPROVED: <i>Gregorio Z. Gamboa, Jr.</i> <b>GREGORIO Z. GAMBOA, Jr., Ed.D</b> SUC PRESIDENT II	CONTENT:	SHEET: NO.: 
--	--	---	--	---	----------	--

**MAIN LIBRARY READING AREA**





LEARNING COMMONS





LA BIBLIOTECA CAFÉ (COFFEE SHOP)



**Space is provided for print resources as well as work stations for electronic resources**

**Periodical Section**

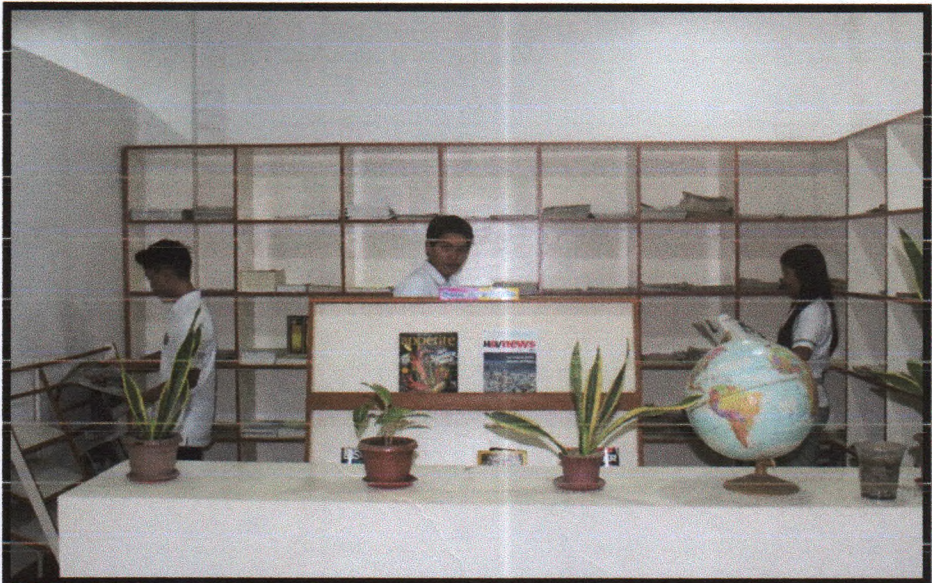

**Circulation Section**



**eLibrary Section**



**Entrance/Exit Section**



