



**SSCT**

*"For Nation's Greater Heights"*

S.4. The reading room can accommodate at least 10% of the school enrollment at any given time.



**SURIGAO STATE COLLEGE OF TECHNOLOGY**

Main campus, Surigao City  
Library Department

**Comparative Data on School's Enrollment against  
seating capacity of 10%**

<b>MAIN LIBRARY</b>	<b>300</b>
<b>LEARNING RESOURCE CENTER</b>	<b>500</b>
<b>TOTAL</b>	<b>800</b>

**SCHOOL ENROLLMENT – 5979 = X 10% = 597.9**





**SSCT LIBRARY can accommodate more than 10% of its  
Enrollment at one sitting**



**READERS' AREA**





 <p>SSCT</p>	<p>COLLEGE LOGO: BY DIRECT SUPERVISION:</p>  <p>AR. MARIEN C. SOLLOSO</p>	<p>PROJECT TITLE:</p> <p>LOCATION MAP</p>	<p>RECOMMENDING APPROVAL:</p>  <p>ROWENA A. DELGADO, Ph.D.</p>	<p>APPROVED:</p>  <p>GREGORIO Z. GAMBIA, Jr., Ed.D.</p>	<p>CONTENT:</p>	<p>SHEET: NO.</p>
<p>SSCT</p>	<p>BY DIRECT SUPERVISION:</p>	<p>LOCATION TITLE:</p>	<p>RECOMMENDING APPROVAL:</p>	<p>APPROVED:</p>	<p>CONTENT:</p>	<p>SHEET: NO.</p>

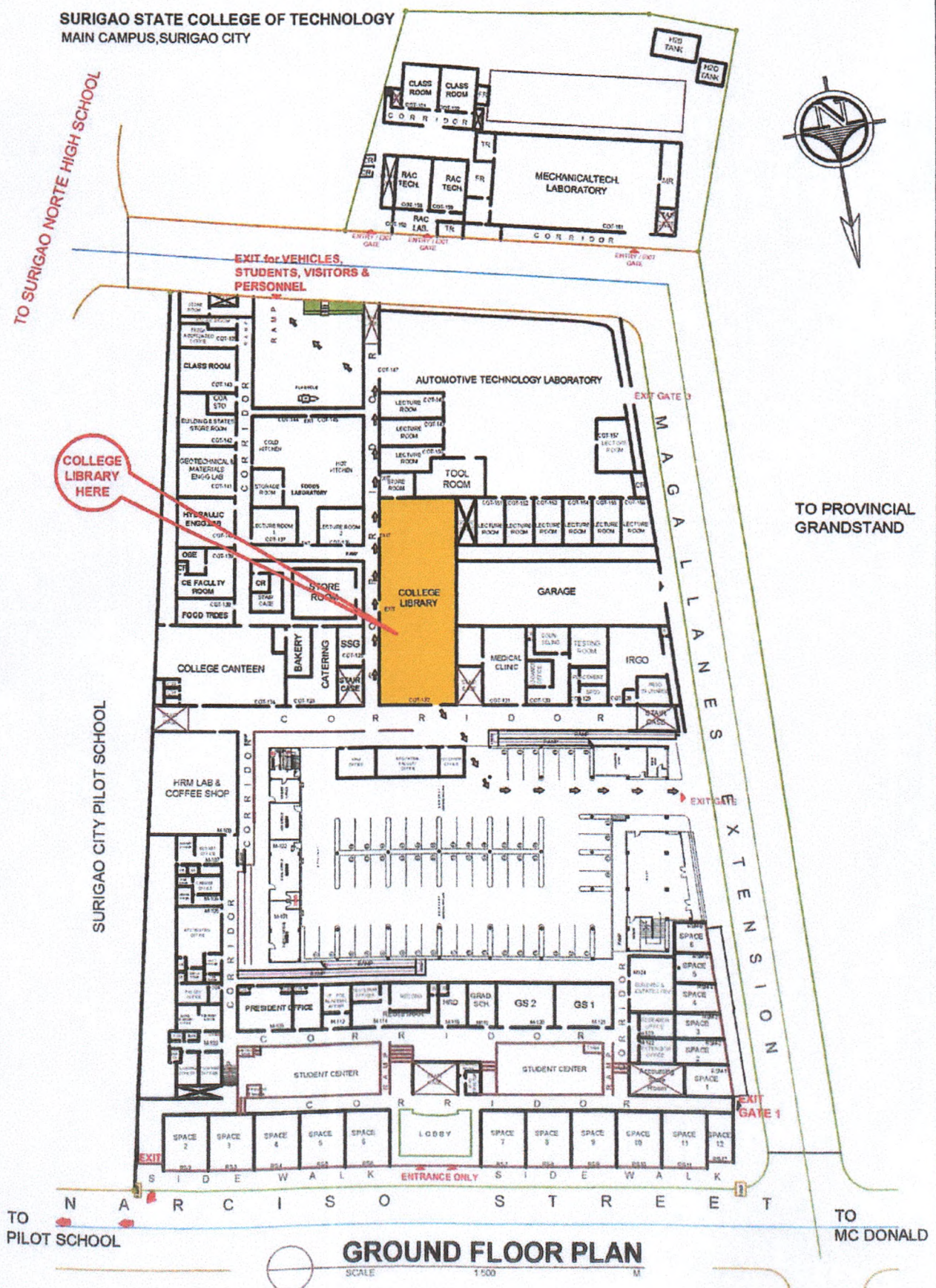

**COLLEGE LIBRARY**



**SURIGAO STATE COLLEGE OF TECHNOLOGY  
MAIN CAMPUS, SURIGAO CITY**

TO SURIGAO NORTE HIGH SCHOOL

**EVACUATION AREA**

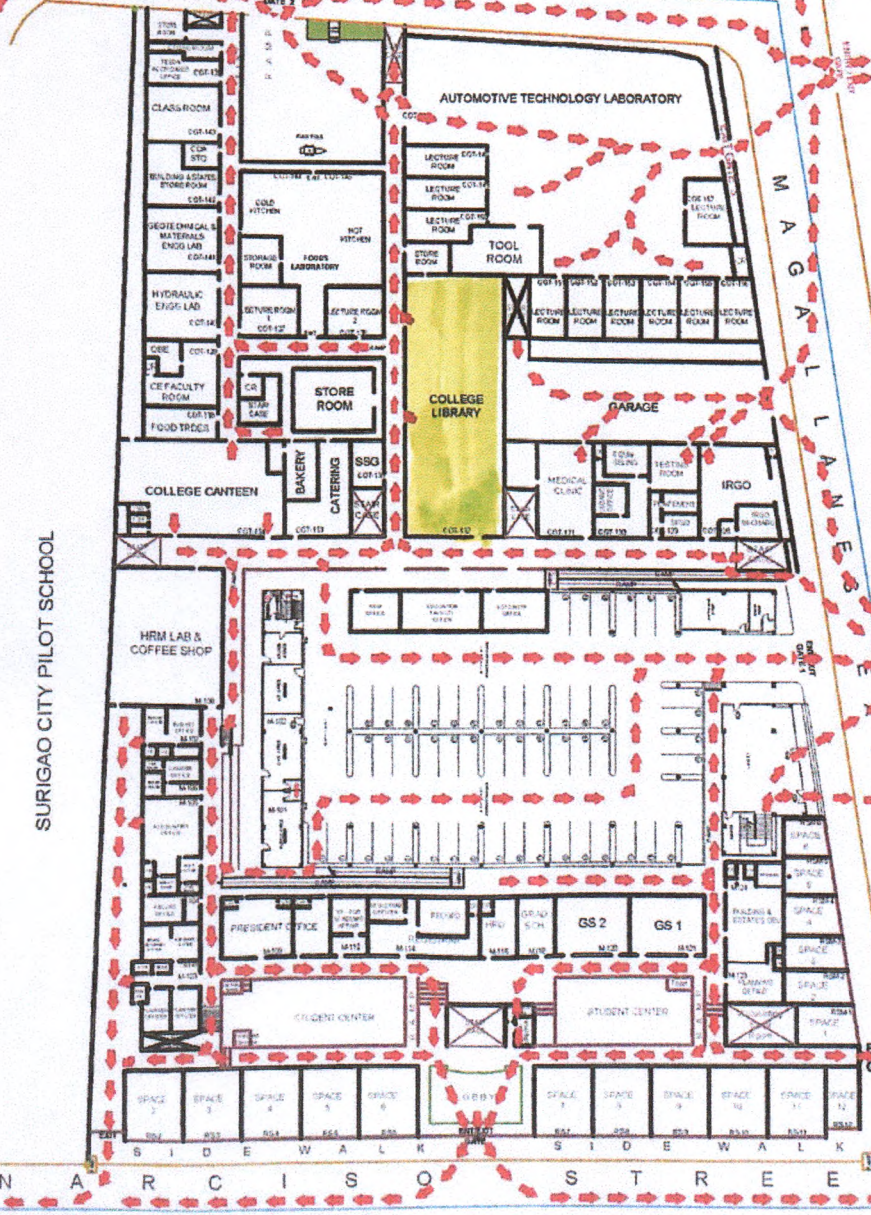

**EMERGENCY NUMBER**

- BFP: 232-7790/827-0318
- CRH: 862-1900/826-3876
- PNP HOTLINE: 09209745322
- PDRRC: 09282105287
- CDRRC: 826-5449/09106217684
- RESCUE: 09294209511

PROVINCIAL SPORTS  
COMPLEX

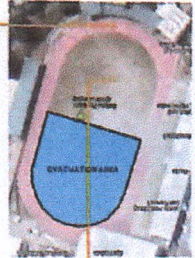

TO PROVINCIAL  
GRANDSTAND

TO PILOT SCHOOL





TO MC DONALD

**GROUND FLOOR PLAN**

SCALE 1:500 M

LOGO:	BY DIRECT SUPERVISION	PROJECT TITLE	RECOMMENDING APPROVAL	APPROVED	SHEET CONTENTS	SHEET NO.
		<b>EMERGENCY EXIT PLAN/ EVACUATION EXIT PLAN</b>				
SSCT	HEAD BUILDINGS & ESTATES	LOCATION: SSCT-MAIN CAMPUS, NARCISO ST., SURIGAO CITY	VICE-PRESIDENT FOR ADMINISTRATION	COLLEGE PRESIDENT		

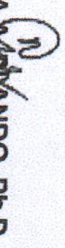

COLLEGE LOGO: 	BY DIRECT SUPERVISION: 	PROJECT TITLE: <b>LOCATION MAP</b>	RECOMMENDING APPROVAL: 	APPROVED: 	CONTENT: 
SSCT	AR. MARLON C. SOLLOSO HEAD BUILDINGS & ESTATES	LOCATION: SSCT-MAIN CAMPUS, SURIGAO CITY, SDN	VICE-PRESIDENT for ADMINISTRATION	GREGORIO Z. GAMBOA, JR., Ed.D. COLLEGE PRESIDENT	SHEET NO.

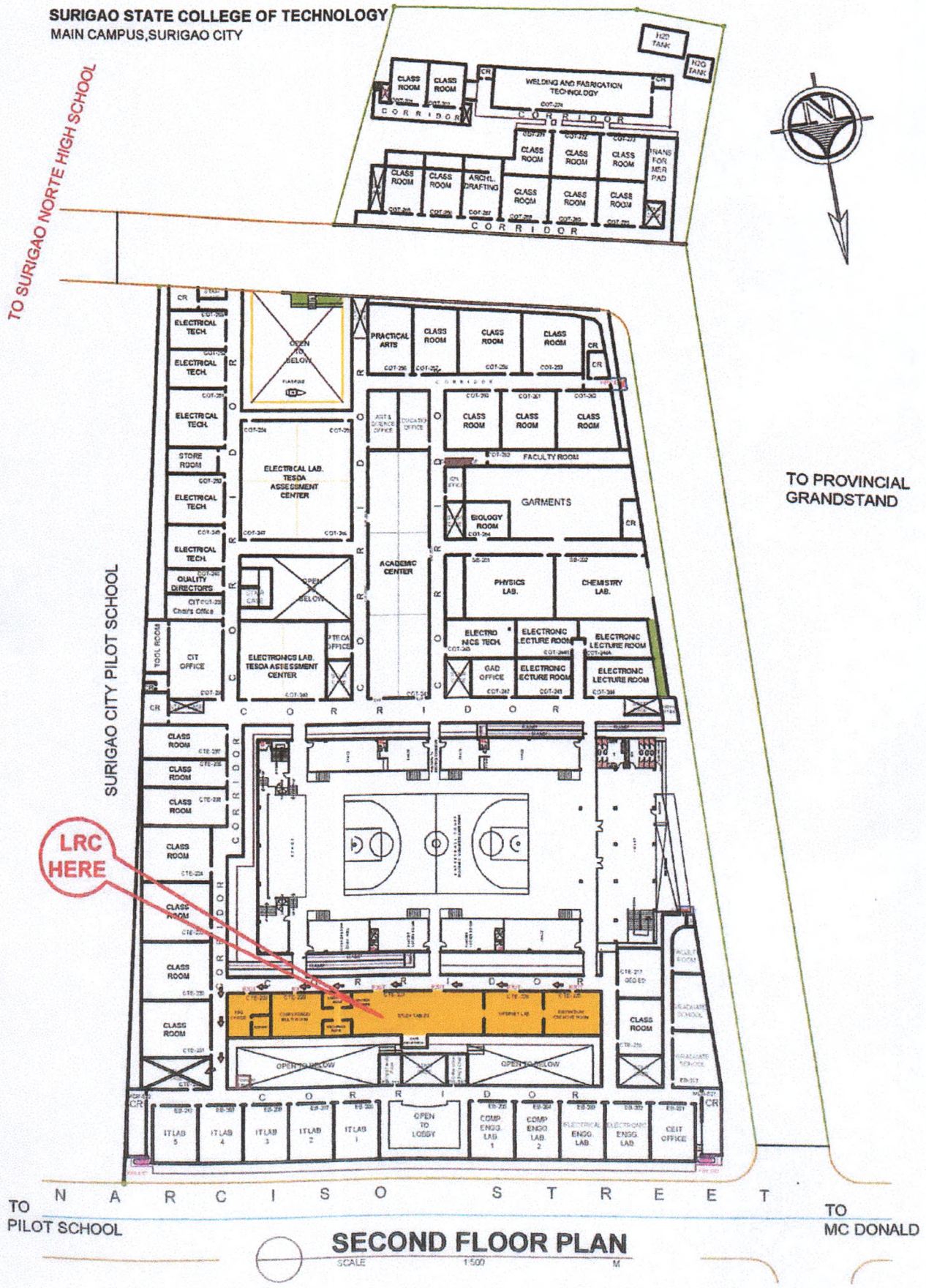

**LEARNING RESOURCE CENTER**



**SURIGAO STATE COLLEGE OF TECHNOLOGY  
MAIN CAMPUS, SURIGAO CITY**

**EVACUATION AREA**



TO SURIGAO NORTE HIGH SCHOOL

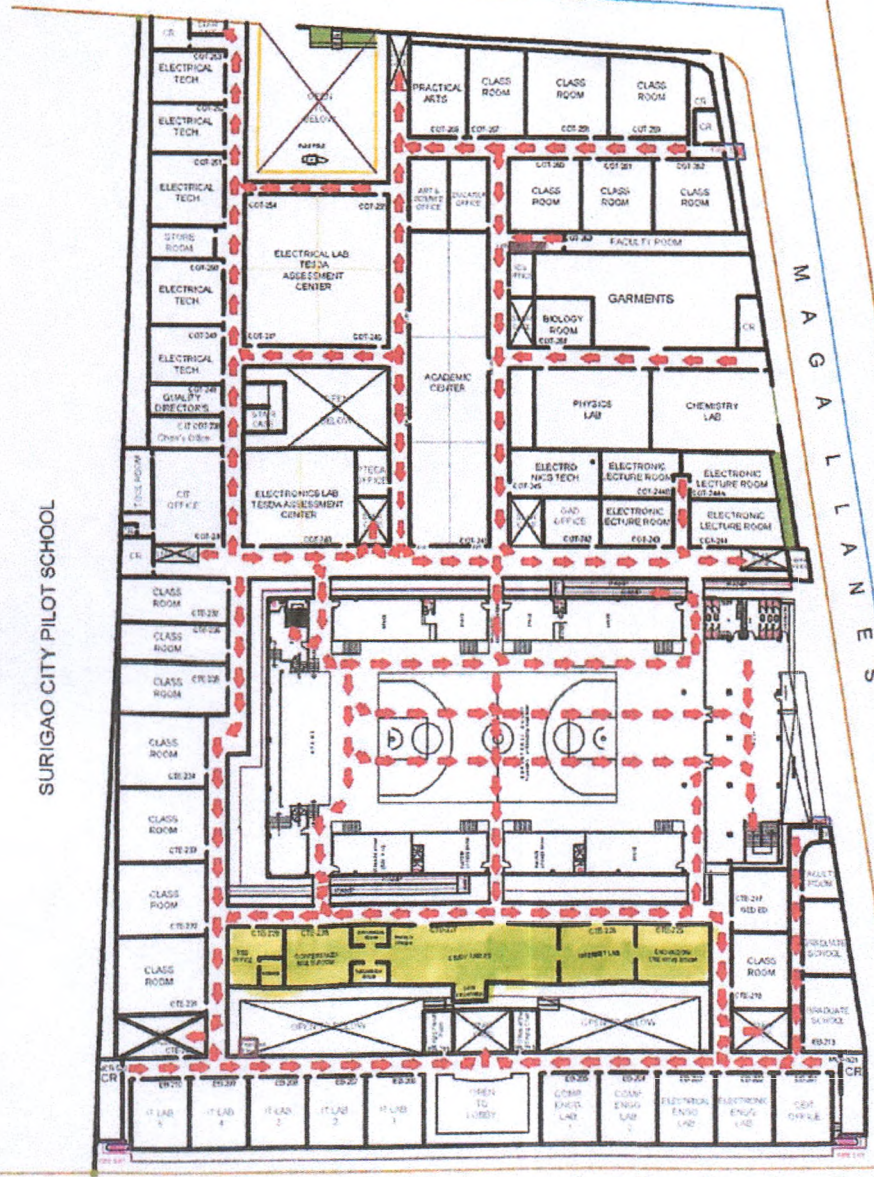

**EMERGENCY NUMBER**

- BFP: 232-7790/827-0318**
- CRH: 862-1800/826-3876**
- PNP HOTLINE: 09209745322**
- PDRRMC: 09282105287**
- CDRRMC: 826-5449/09106217684**
- RESCUE: 09294209511**

PROVINCIAL SPORTS  
COMPLEX

TO PROVINCIAL  
GRANDSTAND

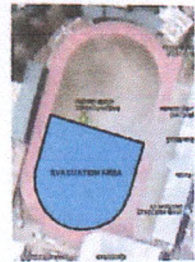

SURIGAO CITY PILOT SCHOOL

MAGALLANES  
EXTENSION

TO  
PILOT SCHOOL

TO  
MC DONALD

N A R C I S O S T R E E T

**SECOND FLOOR PLAN**

SCALE 1:500 M

LOGO	BY DIRECT SUPERVISION	PROJECT TITLE	RECOMMENDING APPROVAL	APPROVED	SHEET CONTENTS	SHEET NO.
	 <b>AR. MARLON C. SOLLOSA</b>	<b>EMERGENCY EXIT PLAN/ EVACUATION EXIT PLAN</b>	 <b>ROWENA A. PANDO, Ph.D.</b> VICE-PRESIDENT for ADMINISTRATION	 <b>GREGORIO Z. GAMBOA, JR., Ed.D.</b> COLLEGE PRESIDENT		
SSCT	HEAD BUILDINGS & ESTATES	LOCATION <b>SSCT-MAIN CAMPUS, NARCISO ST., SURIGAO CITY</b>				



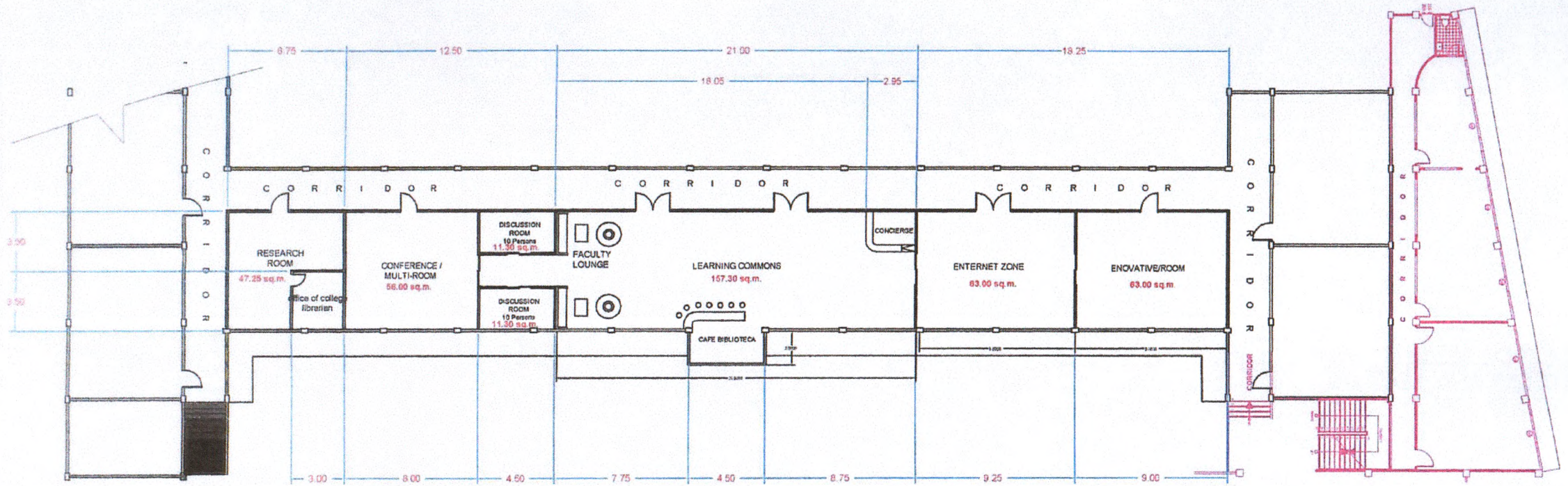





**AREA 555.75 SQ.**

**SECOND FLOOR PLAN**  
SCALE 1:300 M.

**SEATING CAPACITY: 500 STUDENTS  
(LEARNING RESOURCE CENTER)**

COLLEGE LOGO:	BY DIRECT SUPERVISION :	PROJECT TITLE :	RECOMMENDING APPROVAL:	APPROVED:	CONTENT:	SHEET: NO.:
	 <b>AR. MARLON C. SOLLOSO</b> HEAD BUILDINGS & ESTATES	<b>LEARNING RESOURCE CENTER</b> LOCATION: SSCT-MAIN CAMPUS, SURIGAO CITY , SDN	 <b>ROWENA A. PLANDO, Ph.D.</b> VICE-PRESIDENT for ADMINISTRATION	 <b>GREGORIO Z. GAMBOA, Jr., Ed.D</b> COLLEGE PRESIDENT		