



**SSCT**

*"For Nation's Greater Heights"*

S.2. The library is systematically planned to allow future expansion.



SSCT

AR. MARLEN C. SOLLOSO  
HEAD BUILDINGS & ESTATES

LOCATION: SSCT-MAIN CAMPUS, SURIGAO CITY, SDN

ROWENA M. PLANDO, Ph.D.  
VICE-PRESIDENT for ADMINISTRATION

GREGORIO Z. GAMBOA, Jr., Ed.D.  
COLLEGE PRESIDENT

COLLEGE LOGO: BY DIRECT SUPERVISION:

PROJECT TITLE:

RECOMMENDING APPROVAL:

APPROVED:

CONTENT:

SHEET NO.

### LOCATION MAP

**SURIGAO STATE COLLEGE OF TECHNOLOGY**  
MAIN CAMPUS, SURIGAO CITY

TO SURIGAO NORTE HIGH SCHOOL



EXIT for VEHICLES,  
STUDENTS, VISITORS &  
PERSONNEL

COLLEGE LIBRARY  
HERE

TO PROVINCIAL  
GRANDSTAND

SURIGAO CITY PILOT SCHOOL

MAGALLANES  
EXTENSION

TO  
PILOT SCHOOL

TO  
MC DONALD

N A R C I S O S T R E E T

## GROUND FLOOR PLAN

SCALE 1:500 M

# COLLEGE LIBRARY

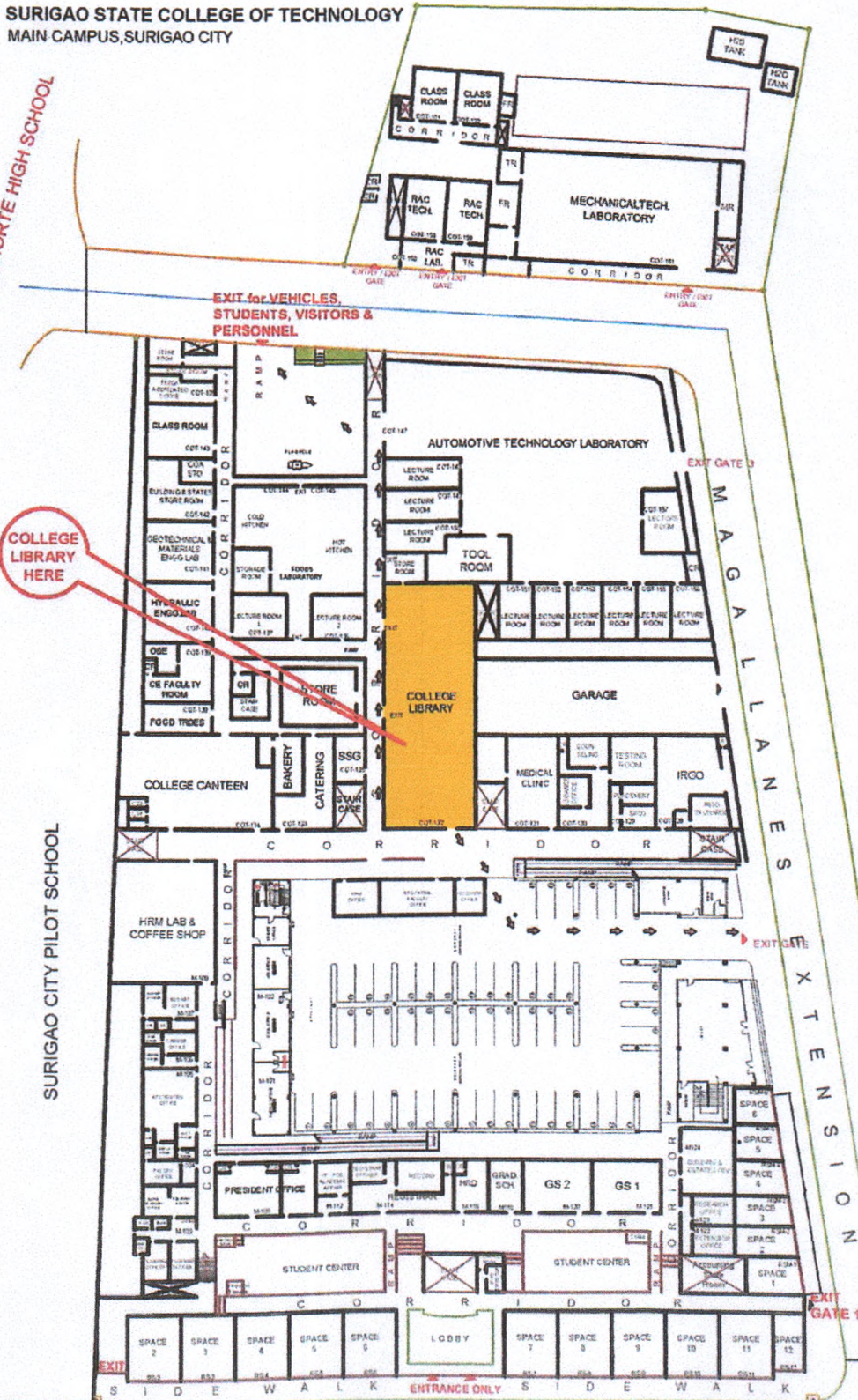

**SURIGAO STATE COLLEGE OF TECHNOLOGY  
MAIN CAMPUS, SURIGAO CITY**

**EVACUATION AREA**



TO SURIGAO NORTE HIGH SCHOOL

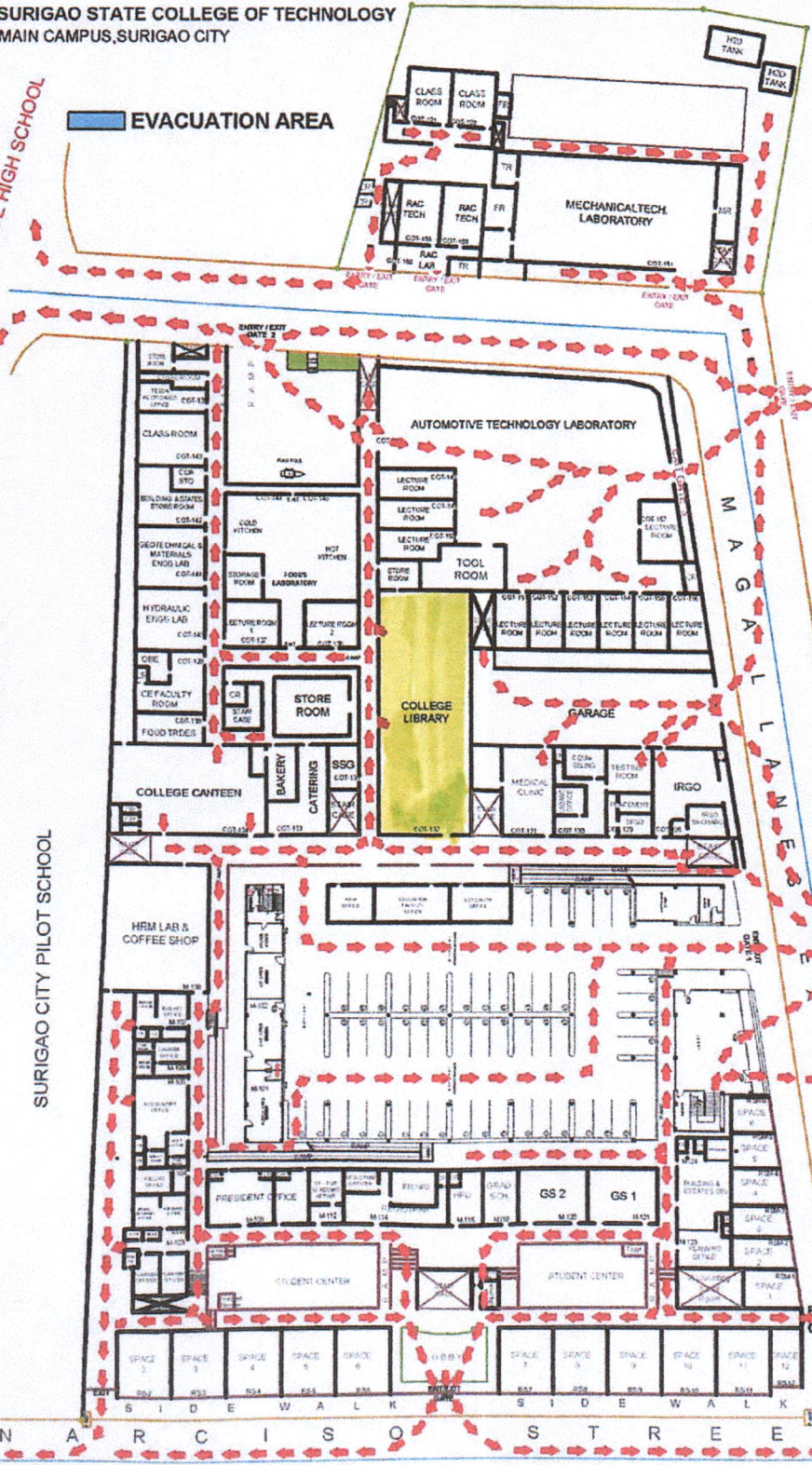

**EMERGENCY NUMBER**

- BFP: 232-7790/827-0318
- CRH: 862-1800/826-3876
- PNP HOTLINE: 09209745322
- PDRRC: 09282105287
- CDRRMC: 826-4449/09106217684
- RESCUE: 09294209511

PROVINCIAL SPORTS  
COMPLEX

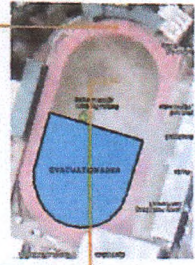

TO PROVINCIAL  
GRANDSTAND

SURIGAO CITY PILOT SCHOOL

EXIT  
GATE 1





TO  
PILOT SCHOOL

TO  
MC DONALD

**GROUND FLOOR PLAN**

SCALE 1:500 M

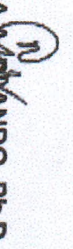
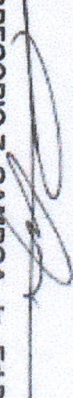
LOGO	BY DIRECT SUPERVISION	PROJECT TITLE	RECOMMENDING APPROVAL	APPROVED	SHEET CONTENTS	SHEET NO.
	 AR. MARLON C. SOLLOSO	<b>EMERGENCY EXIT PLAN EVACUATION EXIT PLAN</b>	 ROWENA A. PRANDO, Ph.D. VICE-PRESIDENT for ADMINISTRATION	 GREGORIO Z. GAMBOA, JR., Ed.D. COLLEGE PRESIDENT		⊕
SSCT	HEAD BUILDINGS & ESTATES	LOCATION: SSCT-MAIN CAMPUS, NARCISO ST., SURIGAO CITY				

COLLEGE LOGO: 	BY DIRECT SUPERVISION: 	PROJECT TITLE: <b>LOCATION MAP</b>	RECOMMENDING APPROVAL: 	APPROVED: 	CONTENT: 
SSCT	AR. MARLON C. SOLLOSO HEAD BUILDINGS & ESTATES	LOCATION: SSCT-MAIN CAMPUS, SURIGAO CITY, SDN	VICE-PRESIDENT for ADMINISTRATION	GREGORIO Z. GAMBOA, JR., Ed.D. COLLEGE PRESIDENT	SHEET: NO.

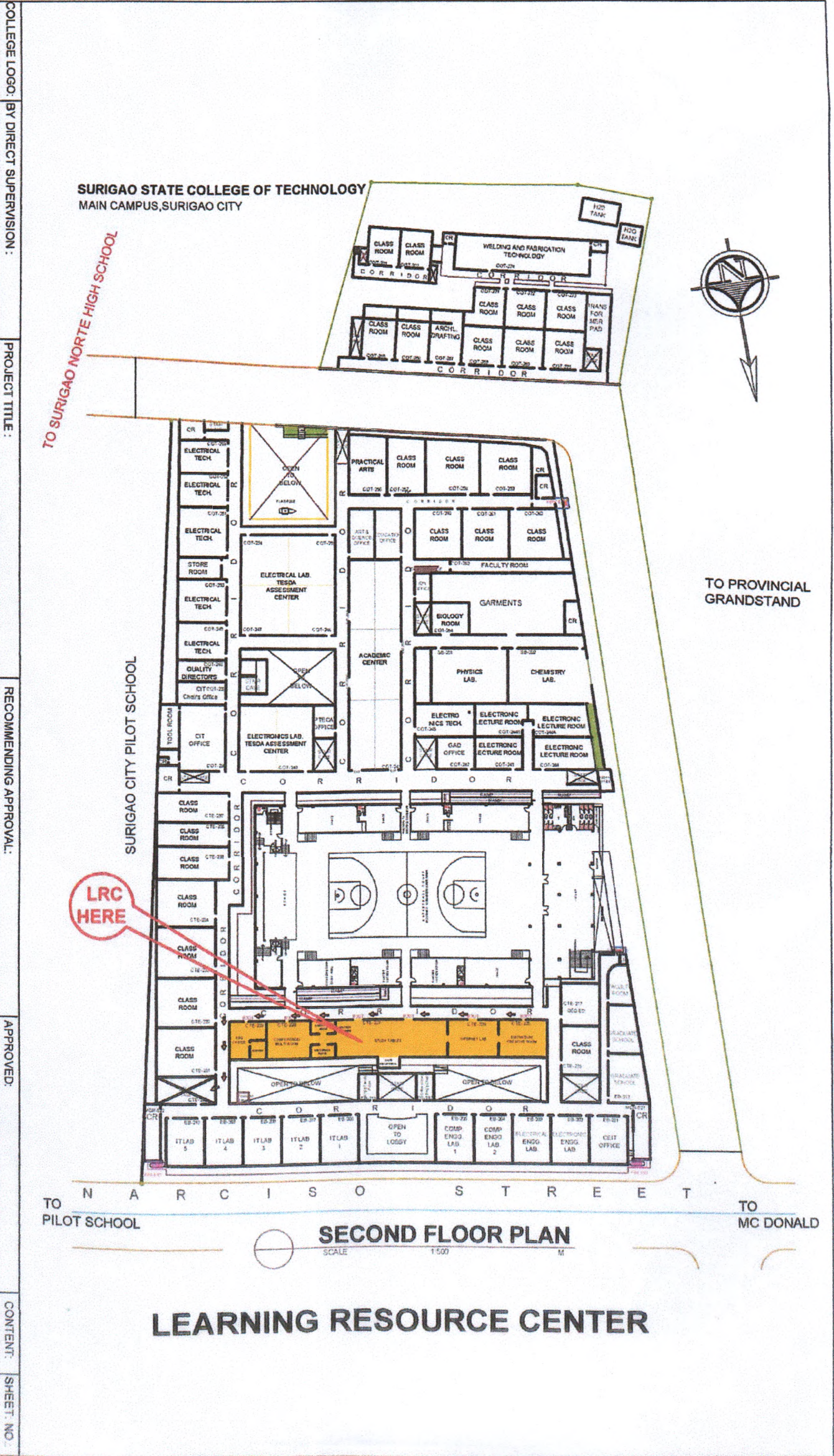

**SURIGAO STATE COLLEGE OF TECHNOLOGY  
MAIN CAMPUS, SURIGAO CITY**

TO SURIGAO NORTE HIGH SCHOOL

**EVACUATION AREA**

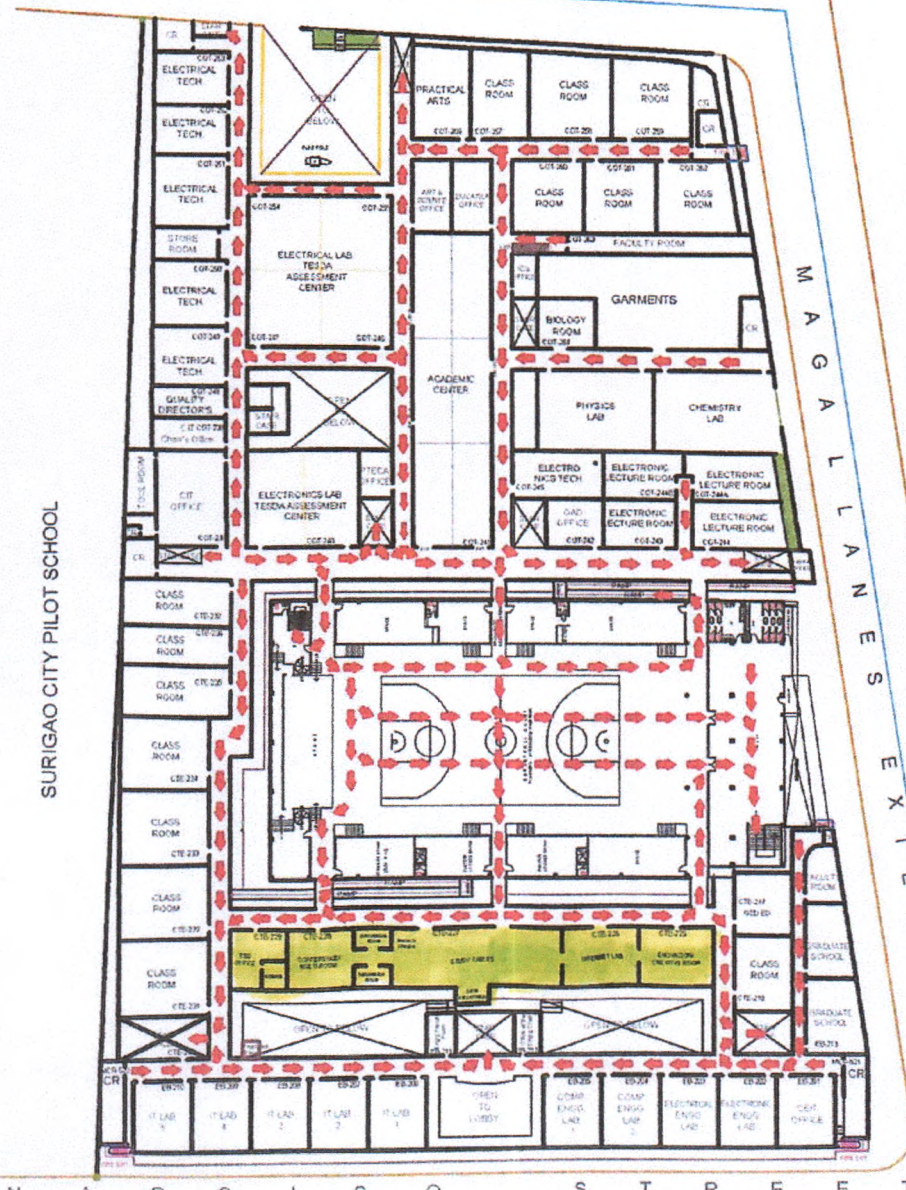

**EMERGENCY NUMBER**  
 BFP: 232-7790/827-0318  
 CRH: 862-1800/826-3876  
 PNP HOTLINE: 09209745322  
 PDRRC: 09282105287  
 CDRRC: 826-5449/09106217684  
 RESCUE: 09294209611

PROVINCIAL SPORTS  
COMPLEX

TO PROVINCIAL  
GRANDSTAND

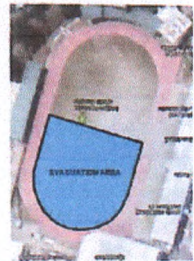

TO PILOT SCHOOL

TO MC DONALD

N A R C I S O S T R E E T

**SECOND FLOOR PLAN**

SCALE 1:500 M

LOGO	BY DIRECT SUPERVISION	PROJECT TITLE	RECOMMENDING APPROVAL	APPROVED	SHEET CONTENTS	SHEET NO.
	 AR. MARLON C. SOLOSO HEAD BUILDINGS & ESTATES	<b>EMERGENCY EXIT PLAN/ EVACUATION EXIT PLAN</b> LOCATION: SSCT-MAIN CAMPUS, NARCISO ST., SURIGAO CITY	 ROWENA A. PRANDO, Ph.D. VICE-PRESIDENT for ADMINISTRATION	 GREGORIO Z. GAMBOA, JR., Ed.D. COLLEGE PRESIDENT		⊕



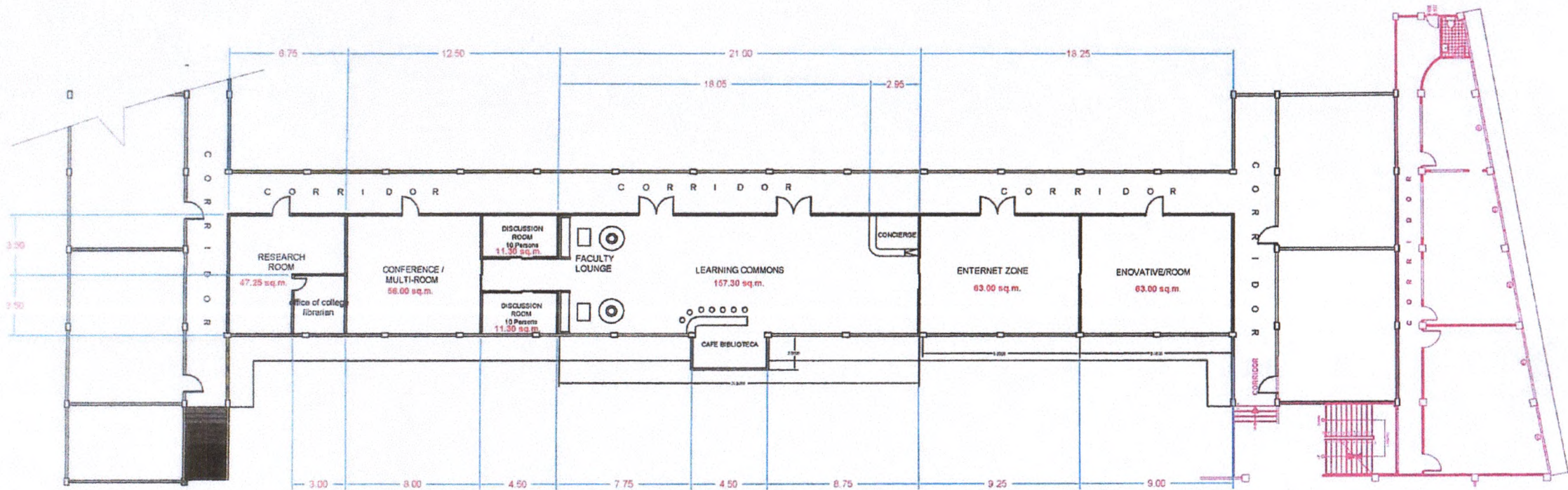

COPYRIGHT © CAD JONAS E. DELACRUZ ALL RIGHTS RESERVED - 2019



**AREA 555.75 SQ.**

**SECOND FLOOR PLAN**  
SCALE 1:300 M.

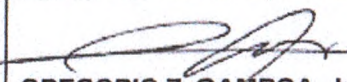
**SEATING CAPACITY: 500 STUDENTS  
(LEARNING RESOURCE CENTER)**

COLLEGE LOGO:	BY DIRECT SUPERVISION:	PROJECT TITLE:	RECOMMENDING APPROVAL:	APPROVED:	CONTENT:	SHEET: NO.:
	 <b>AR. MARLON C. SOLLOSO</b> HEAD BUILDINGS & ESTATES	<b>LEARNING RESOURCE CENTER</b> LOCATION: SSCT-MAIN CAMPUS, SURIGAO CITY, SDN	 <b>ROWENA A. PLANDO, Ph.D.</b> VICE-PRESIDENT for ADMINISTRATION	 <b>GREGORIO Z. GAMBOA, Jr., Ed.D</b> COLLEGE PRESIDENT		



**INNOVATION CENTER**  
SSCT LEARNING RESOURCE CENTER

**INTERIOR  
PERSPECTIVE**



**PROPOSED  
RESOURCE  
LEARNING  
CENTER**



**SSCT MAIN  
CAMPUS**







**INTERNET ROOM**  
SSCT LEARNING RESOURCE CENTER

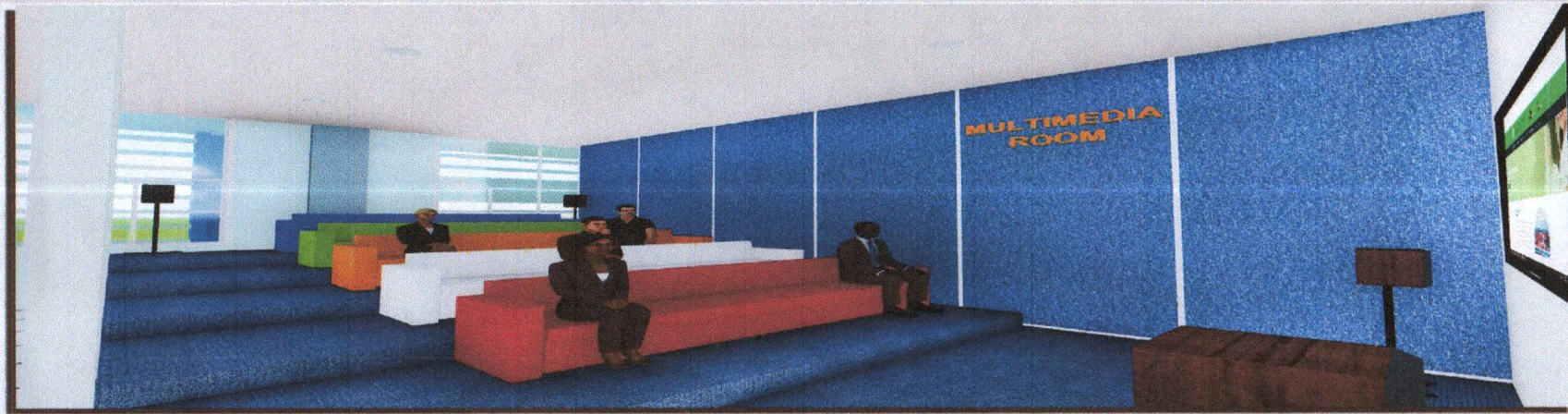

# MULTIMEDIA ROOM

SSCT LEARNING RESOURCE CENTER

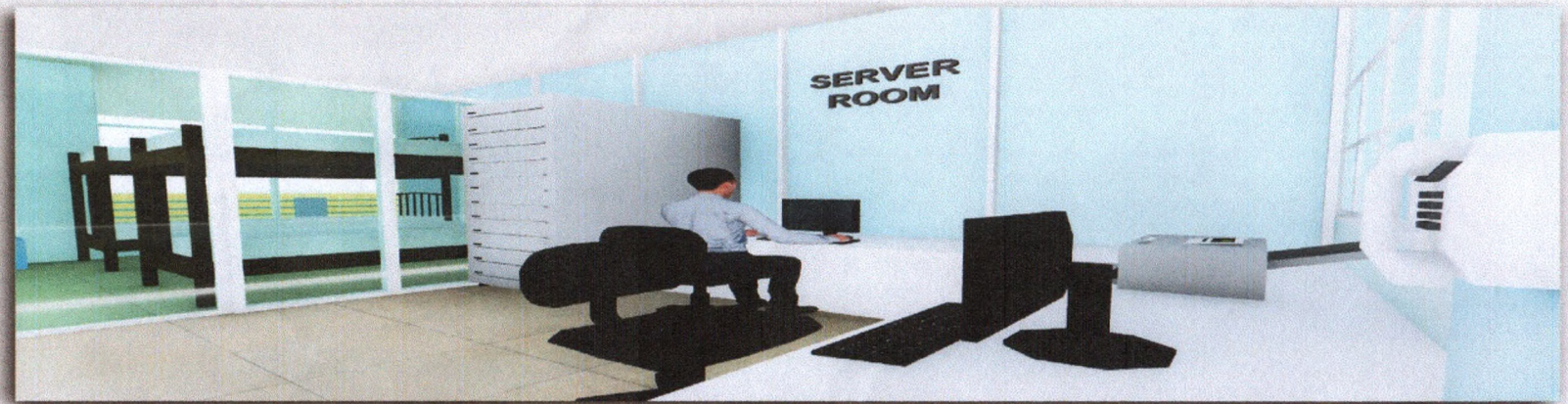
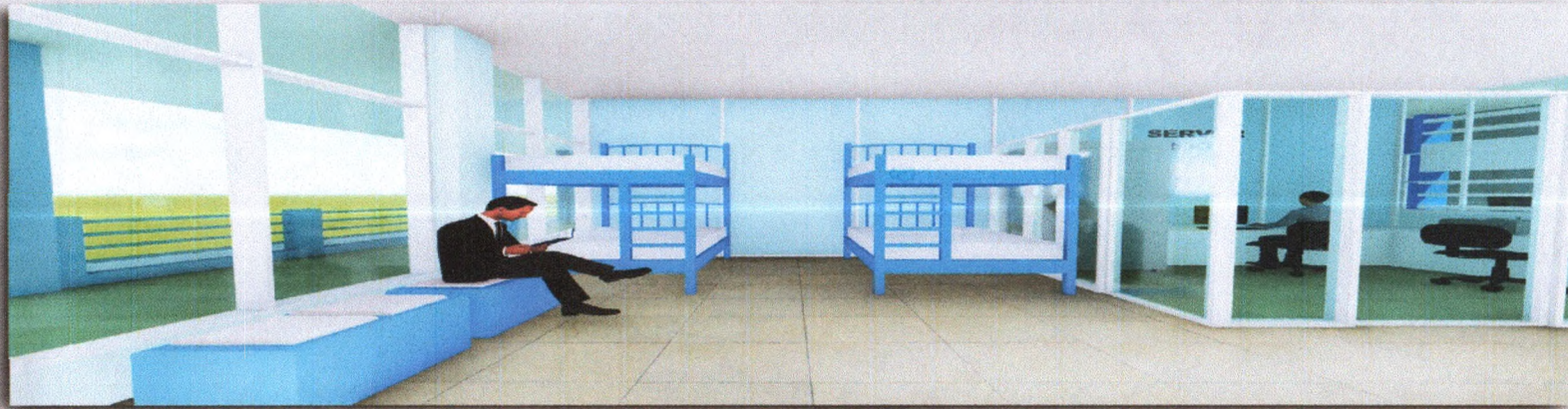

# RESEARCH CORNER

SSCT LEARNING RESOURCE CENTER