

S.9. The buildings
have facilities for
persons with
disability (PWDs)
as provided by
law.



S.9. The buildings have facilities for person with disability (PWD) as provided by law.

LEGEND:



RAMP

RAMP for DISABLE

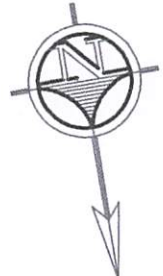

TO SURIGAO NORTE HIGH SCHOOL

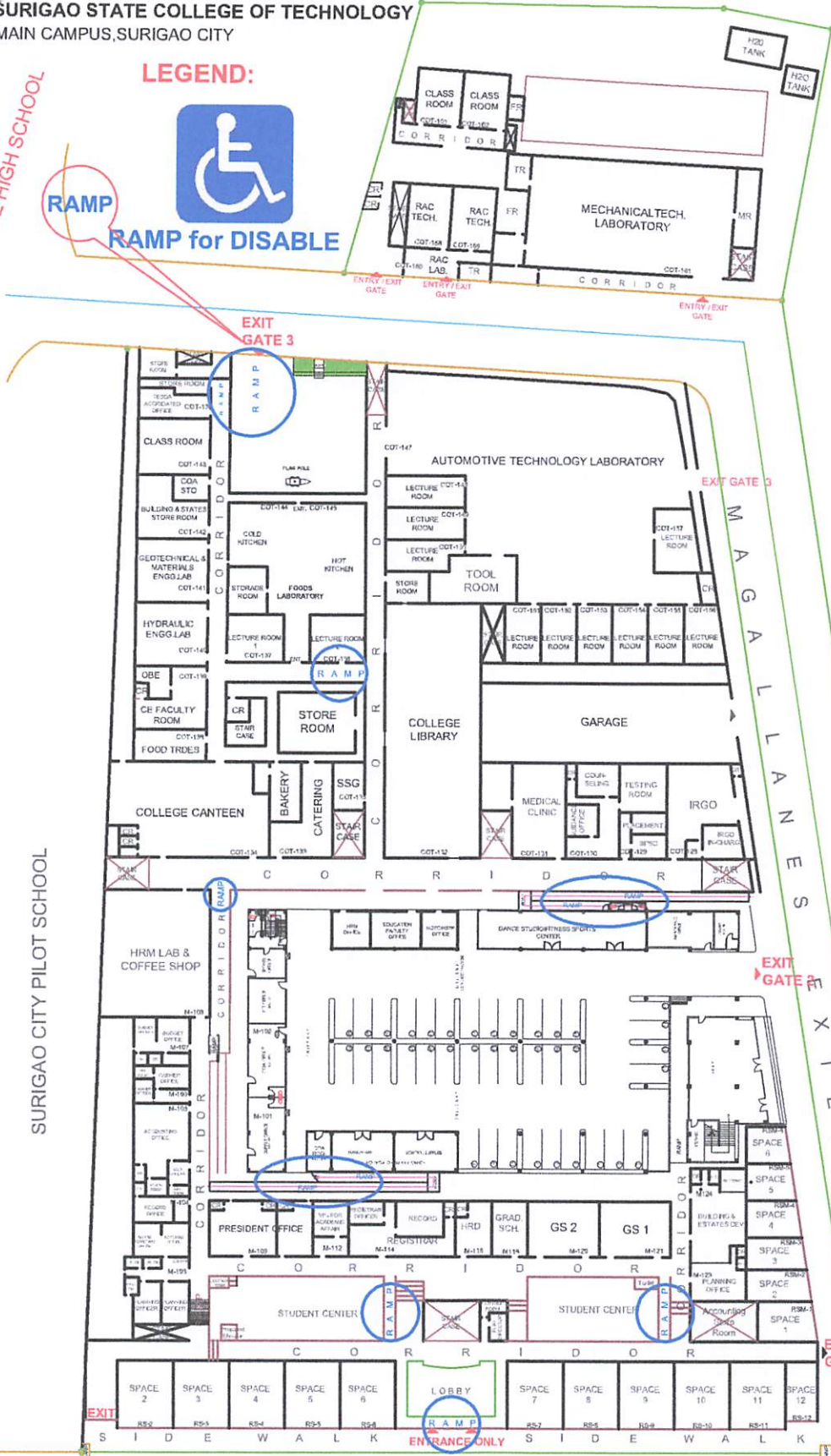

TO PROVINCIAL GRANDSTAND

TO PILOT SCHOOL

TO MC DONALD

GROUND FLOOR PLAN

SCALE 1:500 M.

LOGO:	BY DIRECT SUPERVISION:	PROJECT TITLE:	RECOMMENDING APPROVAL :	APPROVED:	SHEET CONTENTS:	SHEET NO.:
	 AR. MARLON C. SOLLOSO	RAMP for DISABLE	 ROWENA A. PANDO, Ph.D.	 GREGORIO Z. GAMBOA, JR., Ed.D.		
SSCT	HEAD BUILDINGS & ESTATES	LOCATION: SSCT-MAIN CAMPUS, NARCISO ST., SURIGAO CITY	VICE-PRESIDENT for ADMINISTRATION	COLLEGE PRESIDENT		

LEGEND:



RAMP for DISABLE

TO SURIGAO NORTE HIGH SCHOOL

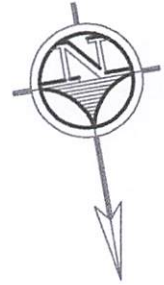

SECOND FLOOR PLAN

SCALE 1:500 M.

LOGO:	BY DIRECT SUPERVISION:	PROJECT TITLE:	RECOMMENDING APPROVAL :	APPROVED:	SHEET CONTENTS:	SHEET NO.:
	 AR. MARLON C. SOLLOSO HEAD BUILDINGS & ESTATES	RAMP for DISABLE	 ROWENA A. PANDO, Ph.D. VICE-PRESIDENT for ADMINISTRATION	 GREGORIO Z. GAMBOA, JR., Ed.D. COLLEGE PRESIDENT		
SSCT		LOCATION: SSCT-MAIN CAMPUS, NARCISO ST., SURIGAO CITY				