

AREA VIII

PHYSICAL

PLANT AND

FACILITIES

**PARAMETER A:
CAMPUS**

SYSTEM-INPUTS AND PROCESSES

S.1. There is a Site Development Plan, ang program of implementation.

SITE DEV. PLAN



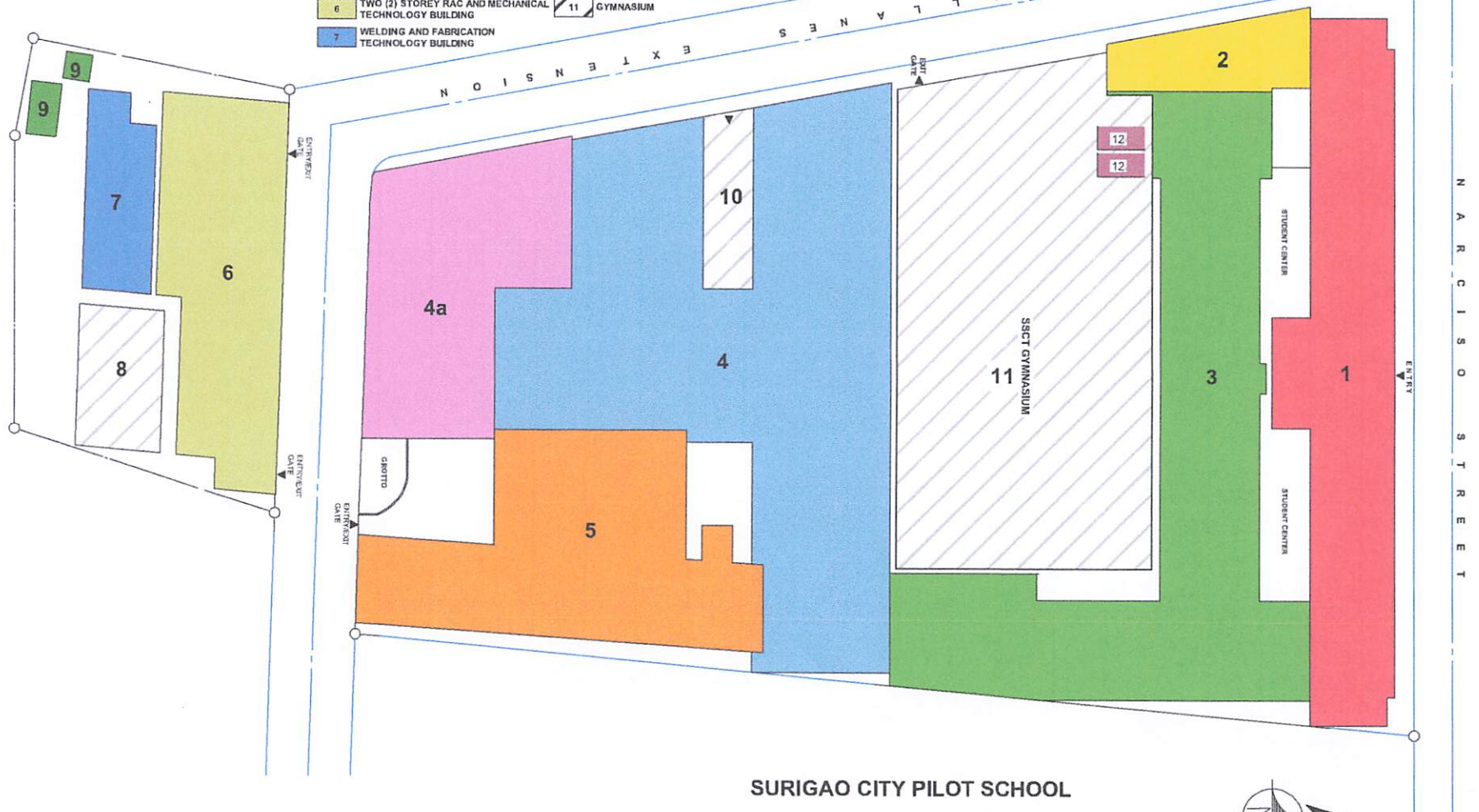

PROVINCIAL SPORTS COMPLEX

LEGEND:

- 1 FIVE (5) STOREY COMMERCIAL AND ENGINEERING BUILDING
- 2 THREE (3) STOREY ANNEX BUILDING
- 3 TWO (2) STOREY RELATED SUBJECTS BUILDING
- 4 TWO (2) STOREY TECHNOLOGY BUILDING
- 4a THREE (3) STOREY TECHNOLOGY BUILDING
- 5 THREE (3) STOREY TVEP BUILDING BUILDING
- 6 TWO (2) STOREY RAC AND MECHANICAL TECHNOLOGY BUILDING
- 7 WELDING AND FABRICATION TECHNOLOGY BUILDING
- 8 THREE (3) STOREY TECHNOLOGY BUILDING
- 9 CONCRETE WATER TANK
- 10 FOUR (4) STOREY SCIENCE BUILDING
- 11 GYMNASIUM
- 12 2 UNITS GENKIT



COPYRIGHT + CAD JONAS E. DELACRUZ ALL RIGHTS RESERVED - 2009

COLLEGE LOGO:	BY DIRECT SUPERVISION:	PROJECT TITLE:	RECOMMENDING APPROVAL:	APPROVED:	CONTENT:	SHEET: NO.:
	 AR. MARLON C. SOLLOSO	SITE DEVELOPMENT PLAN	 ROWENA A. PLANDO, Ph.D.	 GREGORIO Z. GAMBOA, JR., Ed.D.		
SSCT	HEAD BUILDINGS & ESTATES	LOCATION: SSCT-MAIN CAMPUS, SURIGAO CITY	VICE-PRESIDENT for ADMINISTRATION	COLLEGE PRESIDENT		